

DEUBLIN

1109 Series Pop-Off™ Rotor-Mounted Rotating Unions for Coolant Service with Dry Running

- Single passage for coolant or MQL
- Pop-Off™ technology allows unlimited dry running without media pressure
- Full-flow design has no obstructions to trap chips or debris
- Bearing-supported with threaded rotor for easy installation
- Dual ABEC 7 (ISO class P4) angular contact ball bearings
- Labyrinth system and large vents to protect ball bearings
- Balanced mechanical seals made from silicon carbide for long life even under difficult operating conditions
- Anodized aluminum housing resists corrosion



Operating Data

Media	Water-based Coolant MQL (oil mist) up to 10 bar (145 psi)		
Filtration	ISO 4406 Class 17/15/12, max. 60 micron		
Maximum Speed	20,000 min ⁻¹ 20,000 rpm		
Maximum Pressure	See chart		
Maximum Flow	82 l/min	21.6 gpm	Standard
	24.3 l/min	6.4 gpm	High Pressure
Maximum Temperature	71°C	160°F	



**NO AIR PRESSURE
WITH ROTATION**

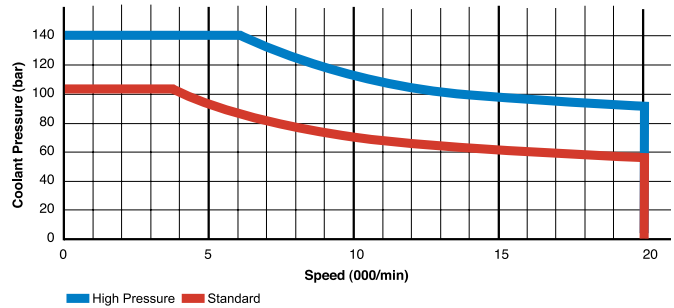

Axial Connection

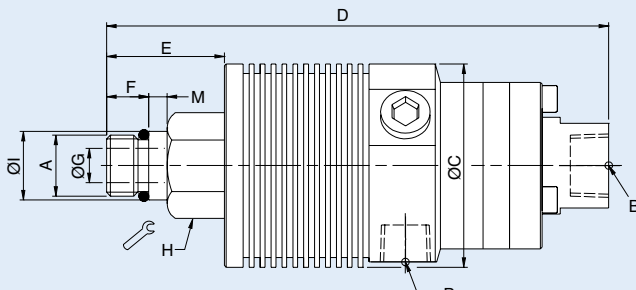

Radial Connection

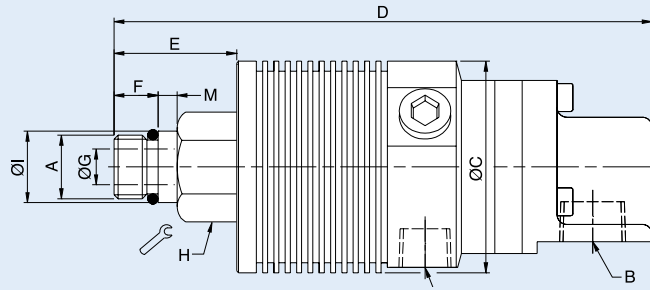

	Ordering Number	B Supply Connection	C Overall Diameter	D Overall Length	P Vent Size (3 X 120°)	A Rotor Connection	E Rotor Length	F Thread Length	G Bore Diameter	H Across Flats	I Pilot Diameter	M Pilot Length
Standard	1109-011-165	3/8" NPT Axial	53	132	1/4" NPT	5/8"-18 UNF LH	34	14	9	15/16"	0.6555" / 0.6553"	5
	1109-021-188	G 3/8" Axial	53	129	G 1/4"	M16 x 1.5 LH	31	11	9	24	17.993 / 17.988	5
	1109-041-188	3/8" PT Axial	53	129	1/4" PT	M16 x 1.5 LH	31	11	9	24	17.993 / 17.988	5
	1109-010-165	3/8" NPT Radial	53	138	1/4" NPT	5/8"-18 UNF LH	34	14	9	15/16"	0.6555" / 0.6553"	5
	1109-020-188	G 3/8" Radial	53	135	G 1/4"	M16 x 1.5 LH	31	11	9	24	17.993 / 17.988	5
	1109-040-188	3/8" PT Radial	53	135	1/4" PT	M16 x 1.5 LH	31	11	9	24	17.993 / 17.988	5
High Pressure	1109-014-196	1/4" NPT Axial	53	132	1/4" NPT	5/8"-18 UNF LH	34	14	9	15/16"	0.6555" / 0.6553"	5
	1109-024-212	G 1/4" Axial	53	129	G 1/4"	M16 x 1.5 LH	31	11	9	24	17.993 / 17.988	5
	1109-044-212	1/4" PT Axial	53	129	1/4" PT	M16 x 1.5 LH	31	11	9	24	17.993 / 17.988	5
	1109-013-196	1/4" NPT Radial	53	138	1/4" NPT	5/8"-18 UNF LH	34	14	9	15/16"	0.6555" / 0.6553"	5
	1109-023-212	G 1/4" Radial	53	135	G 1/4"	M16 x 1.5 LH	31	11	9	24	17.993 / 17.988	5
	1109-043-212	1/4" PT Radial	53	135	1/4" PT	M16 x 1.5 LH	31	11	9	24	17.993 / 17.988	5

美国杜博林 Deublin 旋转接头授权代理

信德迈科技(北京)有限公司 Email: sales@cnmec.biz 010-84282935



DEUBLIN

1109 Series Pop-Off™ Bore-Mounted Rotating Unions for Coolant Service with Dry Running

- Single passage for coolant or MQL
- Pop-Off™ technology allows unlimited dry running without media pressure
- Accepts up to 19 mm of axial drawbar movement
- Full-flow design has no obstructions to trap chips or debris
- Bore-mounted design for easy installation
- Matched, ISO class P4 hybrid ball bearings for smooth operation at high speeds
- Labyrinth system and large vents to protect ball bearings
- Balanced mechanical seals made from silicon carbide for long life even under difficult operating conditions
- Anodized aluminum and stainless steel parts resist corrosion

Operating Data

Media	Water-based Coolant		
	MQL (oil mist) up to 10 bar (145 psi)		
Filtration	ISO 4406 Class 17/15/12,		
	max. 60 micron		
Maximum Speed	See chart		
Maximum Pressure	140 bar	2,030 psi	
Maximum Flow	24.3 l/min	6.4 gpm	
	1109-710-717	82 l/min	21.6 gpm
Maximum Temperature	71°C	160°F	



**NO AIR PRESSURE
WITH ROTATION**

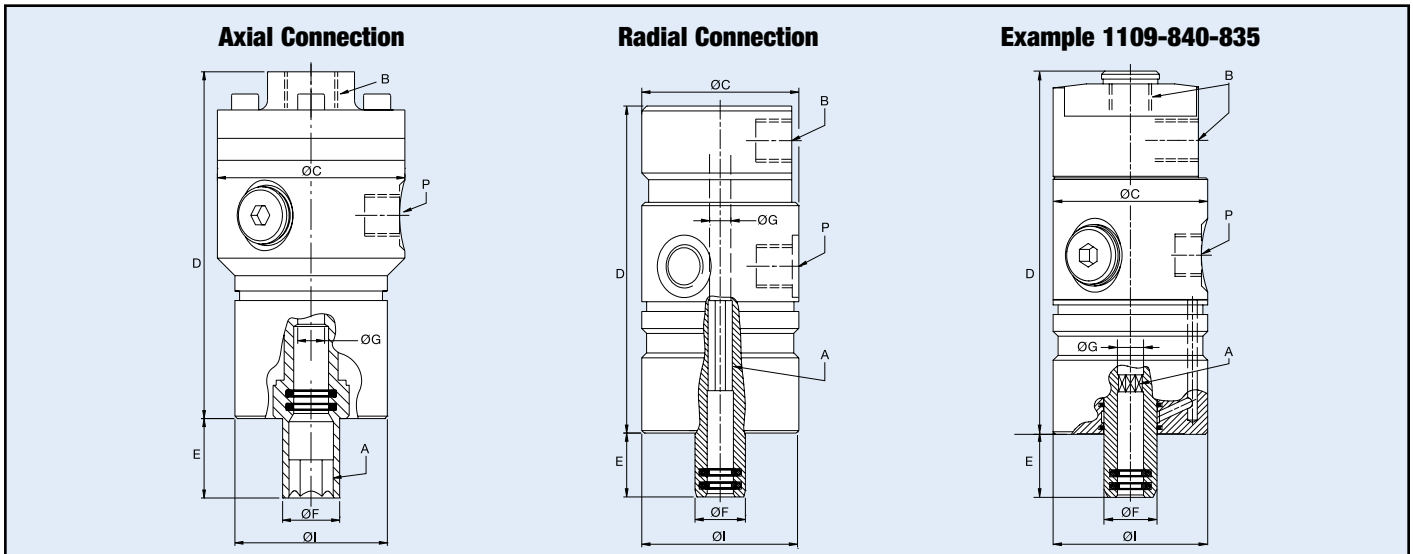
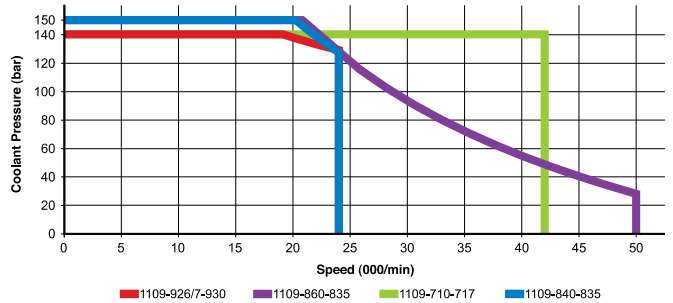

Ordering Number	B Supply Connection	C Overall Diameter	D Housing Length	P Vent Size \emptyset (3 x 120°)	A Rotor Connection	E Rotor Length	F Rotor Overall Diameter	G Bore Diameter	I Pilot Diameter	Maximum Speed (rpm)	Max. Pressure (bar)
1111-002-105*	G 1/4" Radial	48	88.5	4 x G 1/8"	Octagon 7.4 D10	19.5	15.4	8.1 F9	48 h7	24,000	140
1109-710-730	G 3/8" Radial	59	109	G 1/4"	Octagon 9.25 D10	19.5	20	10 F9	48 g6	24,000	140
1109-710-717	G 3/8" Axial	59	109	G 1/4"	Hexagon 12 D10	25.0	18.0	11 H7	48 g6	24,000	140
1109-840-835	G 1/4" Axial & Radial	48	112	G 1/4"	Octagon 7.4 D10	19.5	15.9	8.1 F9	48 g6	24,000	150
1109-842-730	G 3/8" Axial & Radial	48	116	G 1/4"	Octagon 9.25 D10	19.5	16	10 F9	48 g6	24,000	150
1109-926-930	G 1/4" Radial	48	93	G 1/4"	Octagon 7.4 D10	19.5	15.4	8.1 F9	48 h7	42,000	140
1109-927-930	G 1/4" Axial	48	93	G 1/4"	Octagon 7.4 D10	19.5	15.4	8.1 F9	48 h7	42,000	140
1109-860-835	G 1/4" Axial & Radial	48	109	G 1/4"	Octagon 7.4 D10	19.5	16.5	8.1 F9	48 g6	50,000	150

* Ultra-short (0.1 mm) pop-off stroke restricts drainage of residual coolant during tool change.

美国杜博林 Deublin 旋转接头授权代理

信德迈科技(北京)有限公司 Email: sales@cnmec.biz 010-84282935

DEUBLIN