



DEUBLIN

Deu-Plex Air-Hydraulic Hi-Speed Unions

- duoflow design
- self-supported rotating union
- flanged rotor
- radial housing connections
- balanced mechanical seals
- seal combinations:
Carbon Graphite/Hardened Tool Steel - Air
Carbon Graphite/Ceramic - Hydraulic
- full-media flow
- aluminum housing
- cast iron rotor
- oil cup for air service (3-5 drops/month)
- passages should carry same media; inter-passage leakage may occur as seals wear.

Operating Data

Maximum Air Pressure	150 PSI	10 bar
Maximum Vacuum	28" Hg	6.7 kPa
Maximum Hydraulic Pressure ^①	750 PSI	51 bar
Maximum Speed ^①	5,000 RPM	5,000/min
Maximum Temperature	250°F	120°C

^① Operation at maximum pressure combined with maximum speed should be avoided. Pressure rating is for inner passage only. Contact **DEUBLIN** if outer passage or both passages are pressurized.

Typical Duplex Hydraulic

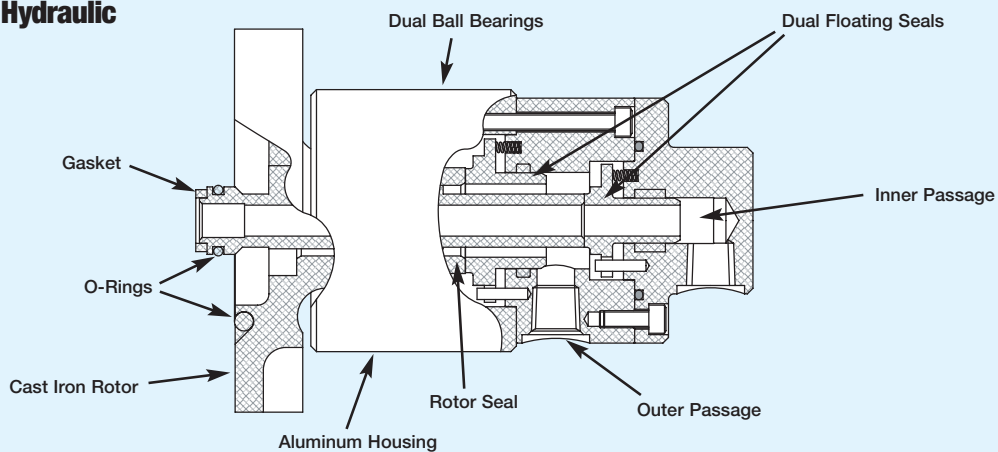

Customer's Shaft End

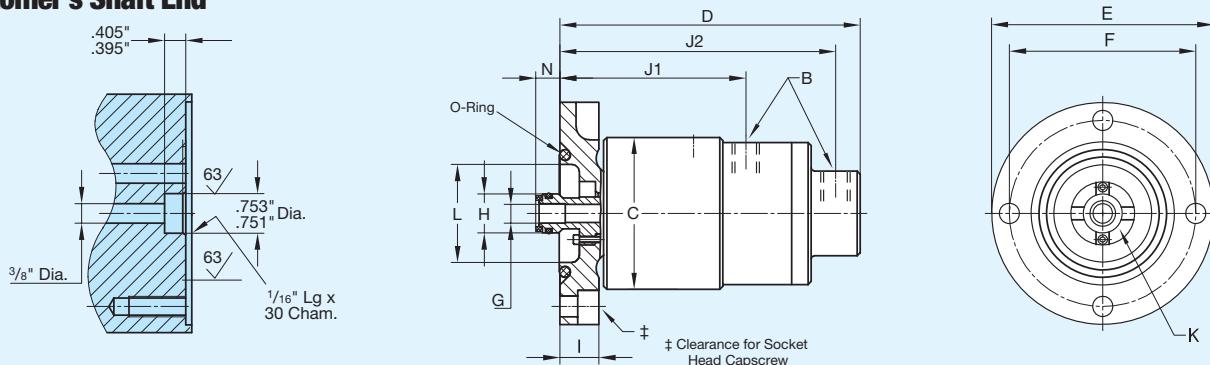

B Port NPT	Ordering No.		C	D	E Pilot	F Bolt Circle	G Area	H	I	J1	J2	K Area	L	N	Screw	Shpg. Wt.
	Air Service	Hydraulic Service														
(2) x 1/4"	2520-000	2520-400	2 ²⁹ / ₃₂ "	5 ³ / ₄ "	4.250" 4.249"	3 ⁹ / ₁₆ "	.093in ²	.750" .748"	3/4"	3 ⁹ / ₁₆ "	5 ⁹ / ₃₂ "	.121in ²	1 ⁷ / ₈ "	7/16"	3/8-16	6#
	2520-033	2520-401	74	146	107.95 107.92	90.5	60mm ²	19.05 19.00	19	91	134	78mm ²	48	11.1	M10	2.7 Kg