



# DEUBLIN

## 3/4" to 1 1/2" Air-Hydraulic Unions

- monoflow design
- self-supported rotating union
- radial housing connection
- balanced mechanical seal
- seal combinations:  
Carbon Graphite/Hardened Tool Steel or  
Carbon Graphite/Ceramic
- felt oiler in seal cavity for air service
- oiler for relubrication (3 - 5 drops/month)
- low torque
- aluminum housing
- stainless steel or steel rotor (respective of model)
- Lubrication Guide page 55

### Operating Data

Maximum Air Pressure	150 PSI	10 bar
Maximum Vacuum	28" Hg	6.7 kPa
Maximum Hydraulic Pressure		
Model 250-094	1,000 PSI	70 bar
Model 355-021	1,000 PSI	70 bar
Model 452-000	750 PSI	50 bar
Maximum Speed NPT Threads	1,500 RPM	1,500/min
Maximum Speed Straight Threads		
Model 250-094	3,500 RPM	3,500/min
Model 355-021	3,000 RPM	3,000/min
Model 452-000	2,500 RPM	2,500/min
Maximum Temperature	250°F	120°C

Union is designed for continuous operation at either maximum speed or maximum pressure. If operating conditions are close to maximum pressure and speed simultaneously, consult **DEUBLIN**.

\* To indicate union with additional "K" port with  
 1/2" NPT: Order Number 250-979-RTR  
 3/4" NPT: Order Number 355-305-RTR  
 1 1/4" NPT: Order Number 452-001-RTR

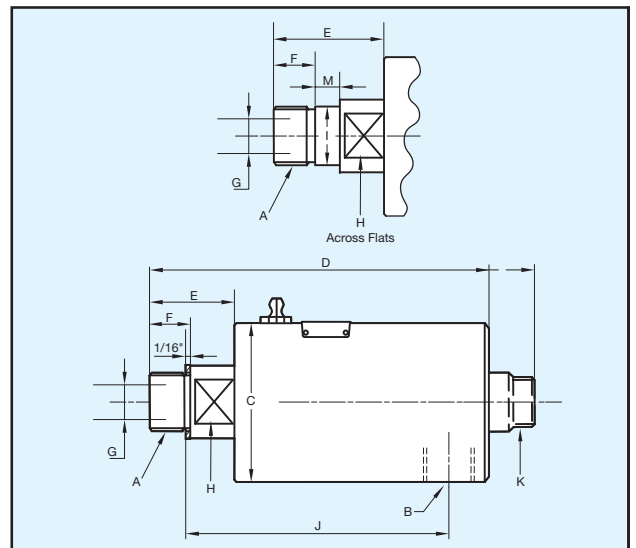

B Port NPT	Ordering No. Model	A Rotor Thread	C	D	E	F	G Rotor Hole	H Across Flats	I Pilot Dia.	J Lock-up	M	Shpg. Wt.
3/4"	250-094-020	3/4" NPT RH	2 7/8"	5 5/8"	1 1/16"	7/8"	1 1/16"	1 1/4"	-	4 1/16"	-	3 1/2#
	250-094-021	3/4" NPT LH										
	250-094-002	1" -14 UNS RH	2 7/8"	5"	1 5/16"	3/4"	2 1/32"	1 1/4"	-	3 11/16"	-	3 1/2#
	250-094-027	1" -14 UNS LH										
	250-094-016	1" -14 UNS (PLT) RH	2 7/8"	5 13/16"	2 1/8"	3/4"	5/8"	1 5/8"	1.2480"	4"	1/2"	3 1/2#
	250-094-017	1" -14 UNS (PLT) LH							1.2478"			
	250-094-284	G 3/4" (BSP) RH	73	128	34	19	17.5	32	-	94	-	1.6 Kg
	250-094-285	G 3/4" (BSP) LH										
	250-094-012	M22x1.5 (PLT) RH	73	122	28	14	14.3	32	26.992	87.5	3	1.6 Kg
250-094-013	M22x1.5 (PLT) LH	26.979										
1"	355-021-002	1" NPT RH	3 1/4"	6 3/16"	1 15/16"	1 1/8"	1"	1 1/2"	-	4 13/16"	-	4 1/2#
	355-021-003	1" NPT LH										
	355-021-019	1 1/2" -12 UNF RH	3 1/4"	6 3/16"	1 15/16"	1 1/8"	1"	1 1/2"	-	4 1/4"	-	4 1/2#
	355-021-074	1 1/2" -12 UNF LH										
	355-021-016	1 1/2" -12 UNF (PLT) RH	3 1/4"	6 9/16"	2 5/16"	1"	1"	1 1/2"	1.5610"	4 3/16"	1/2"	4 1/2#
	355-021-017	1 1/2" -12 UNF (PLT) LH							1.5605"			
	355-021-222	G1" (BSP) RH	82.6	150	42	21	22.2	38	-	108	-	2.1 Kg
355-021-223	G1" (BSP) LH											
1 1/2"	452-000-001	1 1/2" NPT RH	4 1/4"	7 11/16"	2 1/16"	1 3/16"	1 1/2"	2 1/8"	-	5 13/16"	-	9.5#
	452-000-002	1 1/2" NPT LH										
	452-000-395	2" -12 UN RH	4 1/4"	8 1/16"	2 13/16"	1 1/8"	1 1/2"	2 1/8"	-	5 5/8"	-	9.5#
	452-000-396	2" -12 UN LH										
	452-000-029	1 3/4" -12 UN RH	4 1/4"	8 7/16"	3 3/16"	7/8"	1 1/4"	2 1/8"	-	6 1/4"	-	9.5#
	452-000-109	1 3/4" -12 UN LH										
	452-000-198	G1 1/2" (BSP) RH	108	205	72	29	35	54	-	143	-	4.5 Kg
	452-000-199	G1 1/2" (BSP) LH										